

Archaeological Evaluation on Land at Hanningfield Retirement Home, 99 London Road, Sittingbourne, Kent

Site Code: HAN -EV-18

NGR Site Centre 589511 163881

Planning Application Number: 16/508519/FULL



SWAT ARCHAEOLOGY

Swale and Thames Archaeological Survey Company

The Office, School Farm Oast, Graveney Road

Faversham, Kent ME13 8UP

Tel; 01795 532548 or 07885 700 112

info@swatarchaeology.co.uk www.swatachaeology.co.uk

© SWAT Archaeology 2018 all rights reserved

Contents

1	INTRODUCTION	5
1.1	Project Background	5
1.2	Site Description and Topography	5
2	ARCHAEOLOGICAL AND HISTORICAL BACKGROUND.....	5
2.1	Introduction	5
3	AIMS AND OBJECTIVES.....	5
3.1	Specific Aims (KCC 2017).....	5
3.2	General Aims	6
4	METHODOLOGY.....	6
4.1	Introduction	6
4.2	Fieldwork.....	6
4.3	Recording	7
5	RESULTS	7
5.1	Introduction	7
5.2	Stratigraphic Deposit Sequence	7
5.3	Overview	8
6	FINDS	8
6.1	Introduction	8
7	DISCUSSION.....	8
7.1	Archaeological Narrative.....	8
7.2	Conclusions	8
8	ARCHIVE.....	8
8.1	General.....	8

9 **ACKNOWLEDGMENTS** 8

10 **REFERENCES** 9

11 **APPENDIX 1 – TRENCH TABLES** 10

Figures

Figure 1 Site location map

Figure 2 Trench location

Plates 1-6 Trenches

Summary

Swale & Thames Survey Company (SWAT Archaeology) was commissioned to undertake an archaeological evaluation on land at the Hanningfield Retirement Home, Sittingbourne in Kent. The archaeological works were monitored by the Kent County Council Principal Archaeological Officer.

The fieldwork was carried out in August 2018 in accordance with an archaeological specification (SWAT Archaeology 2018) submitted to the Local Planning Authority prior to commencement of works.

The Archaeological Evaluation consisted of 3 trenches, which encountered a relatively common stratigraphic sequence comprising topsoil and subsoil overlying natural geology. The three trenches revealed no archaeological features.

1 INTRODUCTION

1.1 Project Background

1.1.1 Swale & Thames Survey Company (SWAT Archaeology) were commissioned to undertake an archaeological evaluation on land at the Hanningfield Retirement Home, Sittingbourne in Kent (**Figure 1**).The land has planning permission (16/508519/FULL) for the erection of proposed extensions to provide additional bedrooms and to enlarge existing bedrooms.

1.1.2 In mitigation of the potential impact that the development may have on the buried archaeological resource Kent County Council Heritage & Conservation (KKCHC), who provide an advisory service to Swale Borough Council (SBC), requested that the programme of works comprising initially an archaeological evaluation.

1.1.3 The archaeological evaluation was carried out in August 2018 in accordance with an archaeological specification prepared by SWAT Archaeology (2018), prior to commencement of works, and in discussion with Simon Mason Principal Archaeological Officer at KCCHC.

1.1 4 Site Description and Topography

The site is situated on the frontage of London Road with Walnut Close to the side and west of Sittingbourne in the district of Chalkwell. The OS location is NGR 589511 163881 (Figure 1).

The Geological Survey of Great Britain (1:50,000) shows that the PDA is set on Bedrock Geology of Seaford Chalk Formation- Chalk. Superficial deposits are recorded as Head Clay and Silt and the geology on site was Brickearth. The PDA is set at an average height of 18.00m AOD.

2 ARCHAEOLOGICAL AND HISTORICAL BACKGROUND

2.1 Introduction

2.1.1 Details of previous discoveries and investigations within the immediate and wider area may be found in the Kent County Council Historic Environment Record and have been summarised in the Specification produced by SWAT Archaeology (2018).

3 AIMS AND OBJECTIVES

3.1 Specific Aims (SWAT 2018)

3.1.1 The specific aims of the archaeological fieldwork are set out in the Specification (SWAT 2018) were to:

3.1.2 *'The primary objective of the archaeological evaluation is to establish or otherwise the presence of any potential archaeological features which may be impacted by the proposed development. The aims of this investigation are to determine the potential for archaeological activity and in particular the adjacent Roman remains and later archaeological activity.'*

3.1.3 *The programme of archaeological work should be carried out in a phased approach and will commence with a geophysical survey and evaluation through trial trenching. This initial phase should determine whether any significant archaeological remains would be affected by the development and if so what mitigation measures are appropriate. Such measures may include further detailed archaeological excavation, or an archaeological watching brief during construction work or an engineering solution to any preservation in situ requirements'.*

(SWAT Archaeology 2018: 6)

3.2 General Aims

3.2.1 The general aims of the archaeological fieldwork were to;

- establish the presence or absence of any elements of the archaeological resource, both artefacts and ecofacts of archaeological interest across the area of the development;
- ascertain the extent, depth below ground surface, depth of deposit if possible, character, date and quality of any such archaeological remains by limited sample excavation;
- determine the state of preservation and importance of the archaeological resource, if present, and to assess the past impacts on the site and pay particular attention to the character, height/depth below ground level, condition, date and significance of any archaeological deposits.

4 METHODOLOGY

4.1 Introduction

4.1.1 All fieldwork was conducted in accordance with the methodology set out in the Specification (SWAT 2018 and KCC Manual of Specifications 'B') and carried out in compliance with the standards outlined in the Chartered Institute for Archaeologists' Standards Guidance for Archaeological Evaluations (CIfA 2017).

4.2 Fieldwork

4.2.1 A total of three evaluation trenches were excavated across the Site (Figure 1).

4.2.2 Each trench was initially scanned for surface finds prior to excavation. Excavation was carried out using a 360° mechanical excavator fitted with a toothless ditching bucket, removing the

overburden to the top of the first recognisable archaeological horizon, under the constant supervision of an experienced archaeologist.

4.2.3 Where appropriate, trenches, or specific areas of trenches, were subsequently hand-cleaned to reveal features in plan and carefully selected cross-sections through the features were excavated to enable sufficient information about form, development date and stratigraphic relationships to be recorded without prejudice to more extensive investigations, should these prove to be necessary. All archaeological work was carried out in accordance with KCC and ClfA standards and guidance. A complete photographic record was maintained on site that included working shots; during mechanical excavation, following archaeological investigations and during back filling.

4.3 Recording

4.3.1 A complete drawn record of the evaluation trenches comprising both plans and sections, drawn to appropriate scales (1:20 for plans, 1:10 for sections) was undertaken. The plans and sections were annotated with coordinates and aOD heights.

4.3.2 Photographs were taken as appropriate providing a record of excavated features and deposits, along with images of the overall trench to illustrate their location and context. The record also includes images of the Site overall. The photographic record comprises digital photography. A photographic register of all photographs taken is contained within the project archive.

4.3.3 A single context recording system was used to record the deposits. A full list is presented in Appendix 1. Layers and fills are identified in this report thus (100), whilst the cut of the feature is shown [100]. Context numbers were assigned to all deposits for recording purposes. Each number has been attributed to a specific trench with the primary number(s) relating to specific trenches (*i.e.* Trench 1, 101+, Trench 2, 201+, Trench 3, 301+ etc.).

5 RESULTS

5.1 Introduction

5.1.1 A total of three evaluation trenches were mechanically excavated under archaeological supervision.

5.2 Stratigraphic Deposit Sequence

5.2.1 A relatively consistent stratigraphic sequence was recorded across the majority of the Site comprising a mix of topsoil sealing an intact subsoil of brickearth clay.

5.2.2 Appendix 1 provides the stratigraphic sequence for all trenches. Figure 1 provide a site plan and trench location plan while Plates 1-6 include selected site photographs.

5.3 Overview

5.3.1 The three trenches were located across the site to ensure full coverage of potential archaeological remains.

6 FINDS

6.1 No finds of any archaeological merit were recovered from the archaeological evaluation

7 Discussion

7.1 Archaeological Narrative

7.1.1 No archaeological features were recorded in any of the trenches.

7.2 Conclusions

7.2.1 The archaeological evaluation has been successful in fulfilling the primary aims and objectives of the Specification. Development proposals are not likely to impact on archaeological remains.

7.2.2 This evaluation has, therefore, assessed the archaeological potential of land intended for development. The results from this work show that the proposed development is not likely to impact on any archaeological remains.

8 ARCHIVE

8.1 General

8.1.1 The Site archive, which will include; paper records, photographic records, graphics and digital data, will be prepared following nationally recommended guidelines (SMA 1995; ClfA 2009; Brown 2011; ADS 2013).

8.1.2 All archive elements will be marked with the site/accession code, and a full index will be prepared. The physical archive comprises 1 file/document case of paper records & A4 graphics

9 ACKNOWLEDGMENTS

9.1.1 SWAT would like to thank the developer for commissioning the project. Thanks are also extended to Simon Mason Principal Archaeological Officer, Kent County Council, for his advice and assistance.

9.1.2 Peter Cichy supervised the archaeological evaluation and illustrations were produced by Bartek Cichy. Dr Paul Wilkinson MCIfA produced the draft text for this report.

10 REFERENCES

ADS 2013. Caring for Digital Data in Archaeology: a guide to good practice, Archaeology Data Service & Digital Antiquity Guides to Good Practice

Brown, D.H., 2011. Archaeological archives; a guide to best practice in creation, compilation, transfer and curation, Archaeological Archives Forum (revised edition)

Chartered Institute for Archaeologists, 2009, Standard and Guidance for the creation, compilation, transfer and deposition of archaeological archives, Institute for Archaeologists

Chartered Institute for Archaeologists, 2014, *Standard and guidance: for field evaluation*.

Chartered Institute for Archaeologists, 2014, *Standard and guidance for the creation, compilation, transfer and deposition of archaeological archives*.

Compiled by: SWAT Archaeology (PW). The Office, School Farm Oast, Faversham, Kent

Date: 15/10/2018

Appendix 1: Trench Tables

Trench 1	Dimensions: 13.5m x 1.6m Depth: 0.20m Trench alignment: NW-SE NW-end Ground Level: 18.05m aOD, SE-end Ground Level: 18.07m aOD		
Context	Description	Interpretation	Depth (m)
101	Topsoil	Topsoil	0.00-0.20
102	Mid orange brown, clayey sandy silt	Natural	0.20+
103	NW-SE aligned modern trench with iron pipe	Cut of modern service trench	0.20

Trench 2	Dimensions: 9.5m x 1.6m Depth: 0.26m Trench alignment: N-S N-end Ground Level: 18.16m aOD, S-end Ground Level: 18.17m aOD		
Context	Description	Interpretation	Depth (m)
201	Topsoil	Topsoil	0.00-0.20
202	Mid orange brown, clayey sandy silt	Natural	0.26+

Trench 3	Dimensions: 10.3m x 1.6m Depth: 0.29m Trench alignment: NNW-ESE NNW-end Ground Level: 18.65m aOD, ESE-end Ground Level: 18.70m aOD		
Context	Description	Interpretation	Depth (m)
301	Topsoil	Topsoil	0.00-0.21
302	Mid orange brown, clayey sandy silt	Natural	0.26+

Kent County Council HER Summary Form

Site Name: Land at the Hanningfield Retirement Home, 99 London Road, Sittingbourne, Kent

SWAT Site Code: HAN/EV/18

Site Address: As above

Summary:

Swale and Thames Survey Company (SWAT) carried out Archaeological Evaluation on the development site above. The site has planning permission for the erection of residential extensions whereby Swale Borough Council requested that Archaeological works be undertaken to determine the possible impact of the development on any archaeological remains.

The Archaeological Monitoring consisted of an Archaeological Evaluation which revealed no archaeology.

District/Unitary: Swale Borough Council

Period(s):

NGR (centre of site to eight figures) 589511 163881

Type of Archaeological work: Archaeological Evaluation

Date of recording: August 2018

Unit undertaking recording: Swale and Thames Survey Company (SWAT. Archaeology)

Geology: Underlying geology is Bedrock Geology of Seaford Chalk Formation

Title and author of accompanying report: Wilkinson P. (2018) Archaeological Evaluation of Land at Hanningfield Retirement Home, 99 London Road, Sittingbourne, Kent

Summary of fieldwork results (begin with earliest period first, add NGRs where appropriate)

No archaeology found

Location of archive/finds: SWAT. Archaeology. Graveney Rd, Faversham, Kent. ME13 8UP

Contact at Unit: Paul Wilkinson

Date: 15/10/2018



Plate 1: Looking south west at the site



Plate 2: Looking east at the site during excavation of Trench 3



Plate 3: Looking WNW at the site of Trench 1



Plate 4: Looking west-north-west at Trench 1

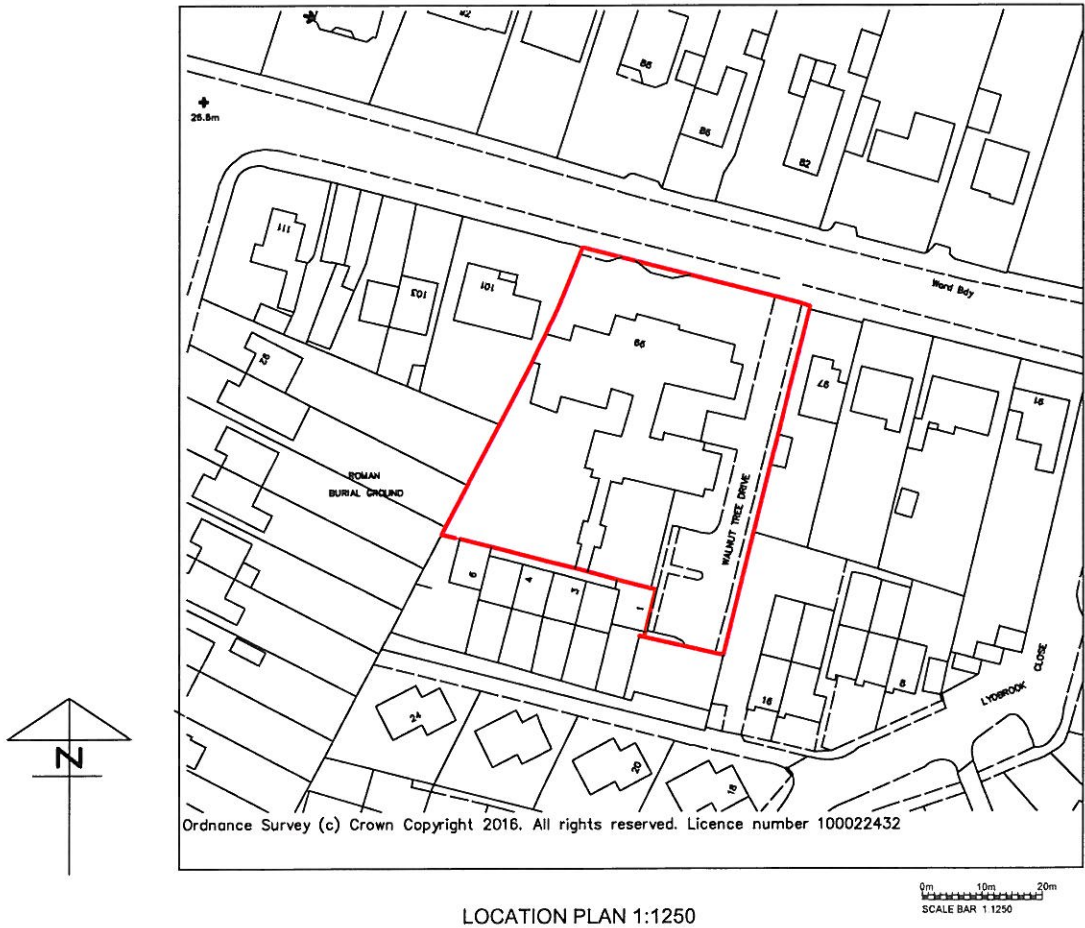

Plate 5: Looking south-west at trench 2



Plate 6: Looking south east at trench 3

Figure 1
Location



LOCATION PLAN 1:1250

Figure 2
Trench Locations

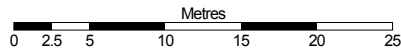

Scale: 1:500

99 London Road

Sittingbourne
ME10 1NR



Supplied by: National Map Centre
License number: 100031961
Produced: 04/01/2018
Serial number: 1930411

Plot centre co-ordinates: 589512,163877
Download file: london.zip
Project name: swat

Figure 1: Trench location